

PLX-PURE LEAD HIGH RATE

PLX12-540 (12V540W)

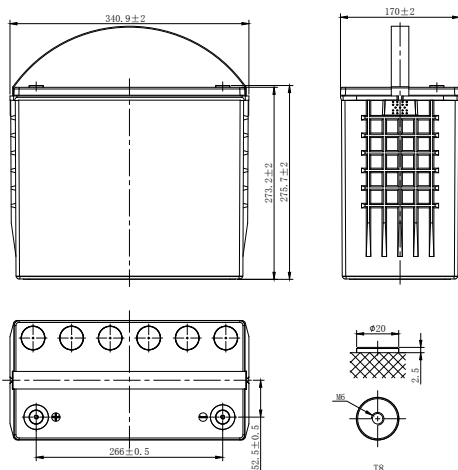

CHARACTERISTICS

Item	Specifications	
Rated Voltage	12V	
Nominal Rate (25°C)	$W_{15}, 1.67V/cell$	540W/cell
Nominal Capacity (25°C)	$C_{10}, 1.80V/cell$	135Ah
Dimension	Length	340.9mm (13.4inches)
	Width	170mm (6.69inches)
	Container Height	273.2mm (10.8inches)
	Total Height	275.7mm (10.9inches)
Approx Weight	43.5kg (95.9lbs)	
Terminal	T8(M6)	
Container Material	PC-ABS (UL94 V-0)	
Short-circuit current	2970A	
Internal Resistance (25°C)	Approx 3.5 mΩ (Fully charged)	
Operating Temp. Range	Discharge	-40~65°C (-40~149°F)
	Charge	0~54°C (32~129°F)
	Storage	-20~40°C (-4~104°F)
Nominal Operating Temp. Range	25±3°C (77±5°F)	
Max.Charging Current (25°C)	0.3C	
Charge voltage (25°C)	Standby Use	Equalization Use
	2.27±0.02V/cell	2.35-2.40V/cell
Temp. Coefficient	-3mV/cell/°C	-4mV/cell/°C
	40°C (104°F)	103%
Effect of temp. to Capacity	25°C (77°F)	100%
	0°C (32°F)	86%
	Self Discharge	PLX series batteries can be stored up to 24 months at 25°C(77°F), For higher temperatures the time interval will be shorter.Battery needs to be given a freshening charge when the OCV approach 2.10V/cell or when the maximum storage time is reached, whichever occurs first.

DISCHARGE TABLE

Constant Current Discharge (Amperes) at 25°C (77°F)															
F.V/Time	5min	10min	15min	20min	30min	45min	1h	1.5h	2h	3h	4h	5h	8h	10h	20h
1.85V/cell	325.6	269.1	216.4	196.7	153.9	108.5	88.4	61.9	48.6	35.9	27.9	24.1	16.2	13.2	6.89
1.80V/cell	375.8	310.2	241.2	215.0	164.4	114.0	92.0	64.6	50.9	37.4	29.0	25.2	16.8	13.5	7.02
1.75V/cell	410.8	339.6	261.3	229.4	175.0	117.2	94.6	66.5	52.4	38.4	29.8	25.8	17.0	13.7	7.10
1.70V/cell	442.6	367.2	278.0	241.3	181.7	121.5	98.2	68.1	53.1	39.1	30.3	26.1	17.2	13.9	7.16
1.67V/cell	494.0	386.8	285.0	250.6	189.0	126.3	100.4	69.5	54.1	39.6	30.7	26.4	17.4	14.0	7.22
1.60V/cell	533.9	393.3	308.0	257.6	192.7	128.2	102.1	70.6	54.9	40.1	31.1	26.7	17.5	14.0	7.27
Constant Power Discharge (Watts/cell) at 25°C (77°F)															
F.V/Time	5min	10min	15min	20min	30min	45min	1h	1.5h	2h	3h	4h	5h	8h	10h	20h
1.85V/cell	645.3	526.2	425.7	389.0	305.8	216.6	177.0	124.2	97.8	72.4	56.7	49.1	33.2	27.2	14.3
1.80V/cell	739.2	600.7	469.7	421.0	324.1	226.0	182.9	128.7	101.6	75.1	58.6	51.1	34.2	27.6	14.5
1.75V/cell	795.8	651.4	504.5	445.2	341.7	230.3	186.7	131.5	103.9	76.6	59.9	51.9	34.5	27.9	14.6
1.70V/cell	838.4	696.5	530.4	463.3	351.2	236.3	192.4	133.9	104.6	77.5	60.5	52.3	34.6	28.1	14.6
1.67V/cell	920.0	728.2	540.0	478.4	363.5	244.0	195.5	135.8	105.9	78.0	61.0	52.5	34.9	28.1	14.6
1.60V/cell	967.7	730.0	578.0	487.0	366.8	245.7	197.0	136.7	106.6	78.2	61.0	52.5	34.9	28.2	14.7

PLX-PURE LEAD HIGH RATE

PLX12-540 (12V540W)



APPLICATIONS

- UPS
- Emergency lighting
- Emergency Power supply
- Electric starting
- Power tools

GENERAL FEATURES

- 15 years design life (25°C)
- Utilizes TPPL technology, thin positive grids and unique manufacturing process to maximize corrosion resistance and service life while increasing energy density
- Specifically designed for high-rate discharge applications
- Wide Wpc range of front and top terminal monoblocs
- UL 94 V-0 Case and cover heat sealed and 100% tested to prevent leaks

STANDARDS

- Compliance with IEC 60896 standards
- Classified as "Very Long Life" according to Eurobat
- CE,UL Approved
- Manufactured in Leoch@IATF 16949, ISO 45001,ISO 9001 and ISO 14001 certified production facilities

Discharge Characteristics

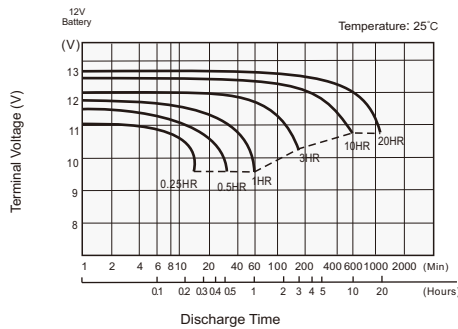

Charging Characteristics

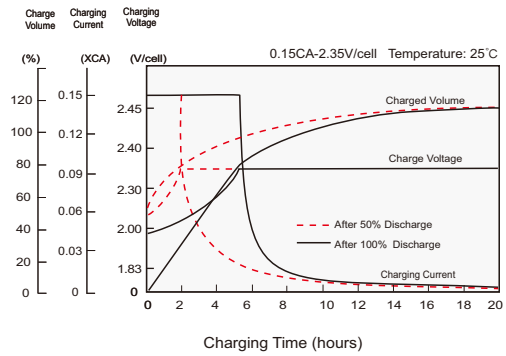

Effects of Temperature on Capacity

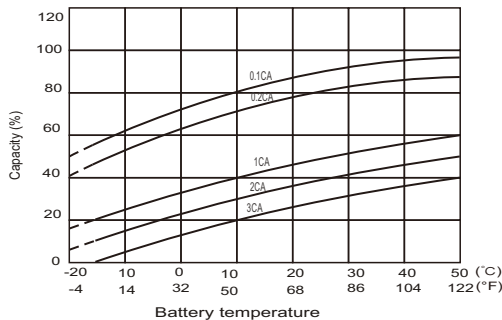

Self Discharge Characteristics

